

# SUBLEASE



## 301 E. COLORADO BOULEVARD, SUITE 600

FOR SUBLEASE

- AVAILABLE:** Shared Spaces - One (1) - two (2) offices and support area.
- SUBLEASE RENTAL:** \$1,200.00 per office per month.
- TERM:** One (1) to three (3) years.
- AVAILABLE:** Immediately.
- PARKING:** Garage: \$65.00 per month per space.  
Roof: \$60.00 per month per space.  
Adjacent Lot: \$40.00 per month per space.
- AMENITIES:**
- High speed fiber optics internet available.
  - Shared Services
    - Access to conference rooms, kitchen and reception. Telephone package also available.
  - Professional, ownership and on-site management team.
  - Walking distance to Old Town Pasadena, and Playhouse District.
  - Close proximity to the 134 & 210 freeways.

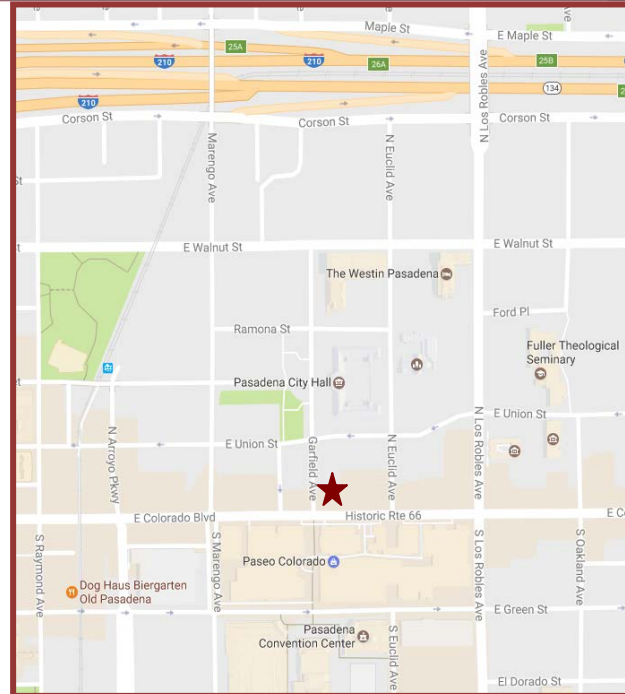

For Further Information, Contact:

Carole Walker  
cwalker@redstonecre.com  
License No. 01525534

Dan Alle  
dalle@redstonecre.com  
License No. 01017941

(626) 795-2255

**Redstone**  
COMMERCIAL REAL ESTATE

All information contained herein is from sources deemed reliable but has not been verified and is submitted without any warranty or representation, expressed or implied, as to its accuracy, and Redstone Commercial Real Estate, License #01525534, assumes no liability for errors or omissions of any kind, change of price, rental or other conditions, including, without limitation, prior sale, lease or financing or withdrawal without notice. This presentation is for information only and under no circumstances whatsoever is to be deemed a contract, note, memorandum or any other form of binding commitment.

# 301 E. Colorado Boulevard Suite 600



Reception



Office



Conference Room



Kitchen



View

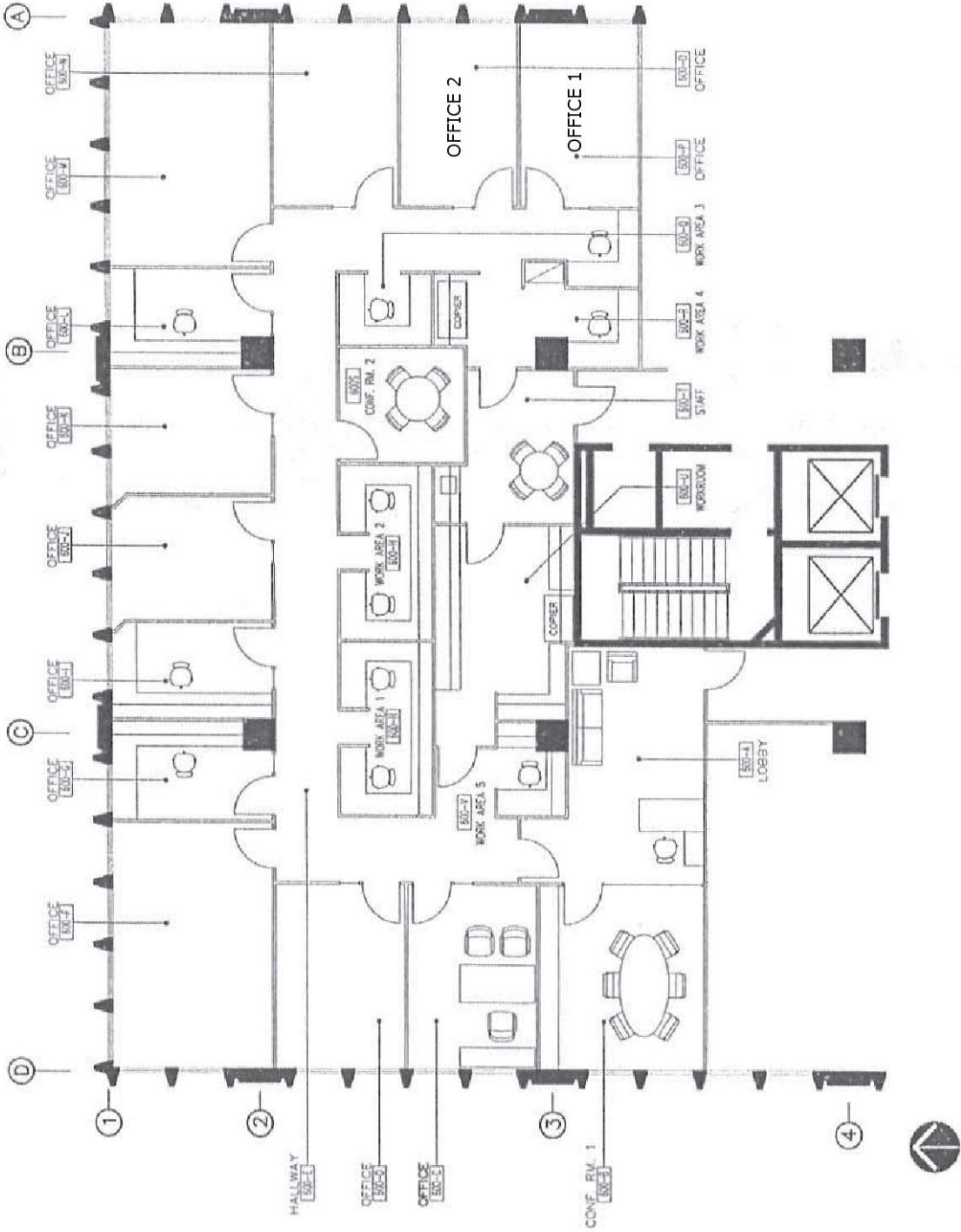

FURNITURE FLOOR PLAN "C-1a"

Approved *11/9/18*  
*Kenneth A. Wano*